

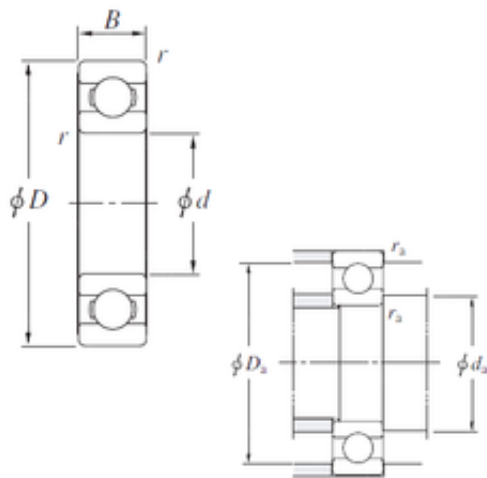

BEARING-SINGAPORE (PTE)LTD.



16092 KOYO Single-row deep groove ball bearings

Bearing No. 16092

Size	460x680x71 mm
Bore Diameter	460 mm
Outer Diameter	680 mm
Width	71 mm
d	460 mm
D	680 mm
B	71 mm
C	71 mm
r min.	5 mm
da min.	480 mm
Da max.	660 mm
ra max.	4 mm
Weight	91,2 Kg
Basic dynamic load rating (C)	431 kN
Basic static load rating (C0)	767 kN
(Grease) Lubrication Speed	630 r/min
(Oil) Lubrication Speed	750 r/min
Bearing No.	16092
r(min)	5
Cr	539
C0r	767
Cu	21.4
f0	16.5
Grease lub.	630
Oil lub.	750

16092 Bearing 2D drawings and 3D CAD models



BEARING-SINGAPORE (PTE)LTD.

da(min)	480
Da(max)	660
ra(max)	4
(Refer.)Mass(kg)	91.2