

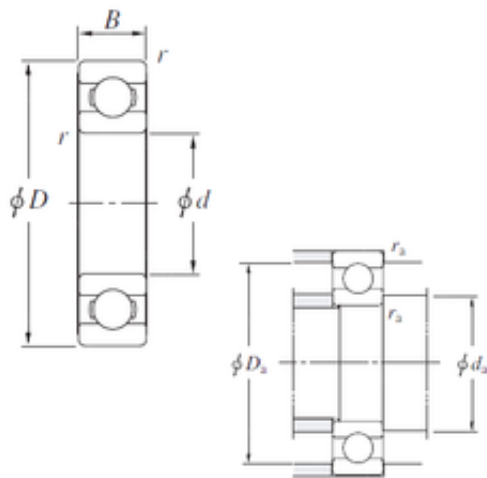

# BEARING-SINGAPORE (PTE)LTD.



## SB610C KOYO Single-row deep groove ball bearings

Bearing No. SB610C

Size	610x849.5x100 mm
Bore Diameter	610 mm
Outer Diameter	849,5 mm
Width	100 mm
d	610 mm
D	849,5 mm
B	100 mm
r min.	6 mm
da min.	634 mm
Da max.	825,5 mm
ra max.	5 mm
Weight	172 Kg
Basic dynamic load rating (C)	659 kN
Basic static load rating (C0)	1370 kN

SB610C Bearing 2D drawings and 3D CAD models